

Send Orders:
sppsales@sigmaco.com
(281) 275-3900



90 Elbow Ductile Iron



FEATURES:



- Dimensions: ANSI B16.3 CLASS 150
- Material: Ductile Iron per ASTM A536 Grade 65-45-12
- Coating: Black
- Threads: Pipe Threads, General Purpose ASME B1.20.1

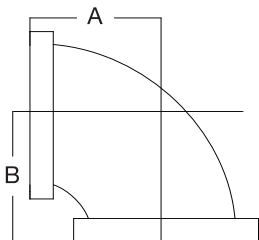

NOM SIZE	ITEM CODE	DIMENSION (IN)		WEIGHT (LBS)
	BLK	A	B	
1"	1D90B0606	1.50	1.50	0.62
1-1/4"	1D90B0707	1.75	1.75	0.90
1-1/2"	1D90B0808	1.94	1.94	1.20
2"	1D90B0909	2.25	2.25	1.85

WARNING This product can expose you to chemicals including lead, which is known to the State of California to cause cancer, and which is known to cause birth defects or other reproductive harm. For more information, go to www.P65Warnings.ca.gov.



12600 CARDINAL MEADOW • SUGAR LAND, TX 77478



SUBJECT TO CHANGE WITHOUT NOTICE. GO TO WEB SITE FOR MOST CURRENT PRODUCT INFORMATIONS AND CHANGES OR CONTACT SIGMA PIPING PRODUCTS SALES REPRESENTATIVE FOR ANY ASSISTANCE.
 SIGMA PIPING PRODUCTS © 2020

SPPSigma.com

Send Orders:
sppsales@sigmaco.com
(281) 275-3900



Reducing Coupling Ductile Iron

FEATURES:

- Dimensions: ANSI B16.3 CLASS 150
- Material: Ductile Iron per ASTM A536 Grade 65-45-12
- Coating: Black
- Threads: Pipe Threads, General Purpose ASME B1.20.1

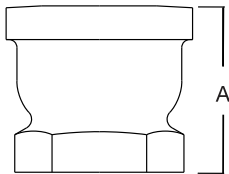

NOM SIZE	ITEM CODE	DIMENSION (IN)	WEIGHT (LBS)
	BLK	A	
1" X 1/2"	1DCR0604	1.69	0.39
1" X 3/4"	1DCR0605	1.69	0.53

WARNING This product can expose you to chemicals including lead, which is known to the State of California to cause cancer, and which is known to cause birth defects or other reproductive harm. For more information, go to www.P65Warnings.ca.gov.



12600 CARDINAL MEADOW • SUGAR LAND, TX 77478



SUBJECT TO CHANGE WITHOUT NOTICE. GO TO WEB SITE FOR MOST CURRENT PRODUCT INFORMATIONS AND CHANGES OR CONTACT SIGMA PIPING PRODUCTS SALES REPRESENTATIVE FOR ANY ASSISTANCE.
 SIGMA PIPING PRODUCTS © 2020

SPPSigma.com

Send Orders:
sppsales@sigmaco.com
(281) 275-3900



90 Reducing Elbow Ductile Iron



FEATURES:



- Dimensions: ANSI B16.3 CLASS 150
- Material: Ductile Iron per ASTM A536 Grade 65-45-12
- Coating: Black
- Threads: Pipe Threads, General Purpose ASME B1.20.1

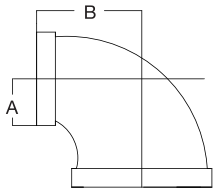

NOM SIZE	ITEM CODE	DIMENSION (IN)		WEIGHT (LBS)
		A	B	
1" X 1/2"	1D90R0604	1.26	1.36	0.44
1" X 3/4"	1D90R0605	1.37	1.45	0.52
1 1/4" X 1/2"	1D90R0704	1.34	1.53	0.64
1 1/4" X 3/4"	1D90R0705	1.45	1.62	0.72
1 1/4" X 1"	1D90R0706	1.58	1.67	0.75
1 1/2" X 1"	1D90R0806	1.65	1.80	0.92
1 1/2" X 1 1/4"	1D90R0807	1.82	1.88	1.08
2" X 1/2"	1D90R0904	1.49	1.88	1.08
2" X 3/4"	1D90R0905	1.60	1.97	1.24
2" X 1"	1D90R0906	1.73	2.02	1.40
2" X 1 1/4"	1D90R0907	1.90	2.10	1.52
2" X 1 1/2"	1D90R0908	2.02	2.16	1.65

WARNING This product can expose you to chemicals including lead, which is known to the State of California to cause cancer, and which is known to cause birth defects or other reproductive harm. For more information, go to www.P65Warnings.ca.gov.



12600 CARDINAL MEADOW • SUGAR LAND, TX 77478



SUBJECT TO CHANGE WITHOUT NOTICE. GO TO WEB SITE FOR MOST CURRENT PRODUCT INFORMATIONS AND CHANGES OR CONTACT SIGMA PIPING PRODUCTS SALES REPRESENTATIVE FOR ANY ASSISTANCE.
 SIGMA PIPING PRODUCTS © 2020

SPPSigma.com

Send Orders:
sppsales@sigmaco.com
(281) 275-3900



Straight Tee Ductile Iron

FEATURES:

- Dimensions: ANSI B16.3 CLASS 150
- Material: Ductile Iron per ASTM A536 Grade 65-45-12
- Coating: Black
- Threads: Pipe Threads, General Purpose ASME B1.20.1

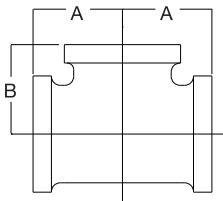

NOM SIZE	ITEM CODE	DIMENSION (IN)		WEIGHT (LBS)
		A	B	
1"	1DT060606	1.50	1.50	0.85
1-1/4"	1DT070707	1.75	1.75	1.22
1-1/2"	1DT080808	1.94	1.94	1.55
2"	1DT090909	2.25	2.25	2.45

WARNING This product can expose you to chemicals including lead, which is known to the State of California to cause cancer, and which is known to cause birth defects or other reproductive harm. For more information, go to www.P65Warnings.ca.gov.



12600 CARDINAL MEADOW • SUGAR LAND, TX 77478



SUBJECT TO CHANGE WITHOUT NOTICE. GO TO WEB SITE FOR MOST CURRENT PRODUCT INFORMATIONS AND CHANGES OR CONTACT SIGMA PIPING PRODUCTS SALES REPRESENTATIVE FOR ANY ASSISTANCE.
 SIGMA PIPING PRODUCTS © 2020

SPPSigma.com

Send Orders:
sppsales@sigmaco.com
(281) 275-3900



Reducing Tee Ductile Iron



FEATURES:



- Dimensions: ANSI B16.3 CLASS 150
- Material: Ductile Iron per ASTM A536 Grade 65-45-12
- Coating: Black
- Threads: Pipe Threads, General Purpose ASME B1.20.1

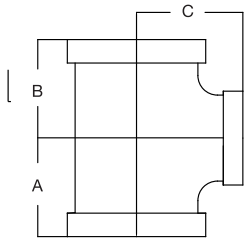

NOM SIZE	ITEM CODE BLK	DIMENSION (IN)			WEIGHT (LBS)
		A	B	C	
1" x 1" x 1/2"	1DT060604	1.26	1.26	1.36	0.64
1" x 1" x 3/4"	1DT060605	1.37	1.37	1.45	0.73
1" x 1/2" x 1"	1DT060406	1.50	1.36	1.50	0.71
1" x 3/4" x 1"	1DT060506	1.50	1.45	1.50	0.76
1" x 1" x 1 1/4"	1DT060607	1.67	1.67	1.58	0.98
1" x 1" x 1 1/2"	1DT060608	1.80	1.80	1.65	1.16
1 1/4" x 1" x 1/2"	1DT070604	1.34	1.26	1.53	0.82
1 1/4" x 1" x 3/4"	1DT070605	1.45	1.37	1.62	0.90
1 1/4" x 1" x 1"	1DT070606	1.58	1.50	1.67	1.00
1 1/4" x 1" x 1 1/4"	1DT070607	1.75	1.67	1.75	1.08
1 1/4" x 1" x 1 1/2"	1DT070608	1.88	1.88	1.82	1.42
1 1/4" x 1 1/4" x 1/2"	1DT070704	1.34	1.34	1.53	0.86
1 1/4" x 1 1/4" x 3/4"	1DT070705	1.45	1.45	1.62	0.92
1 1/4" x 1 1/4" x 1"	1DT070706	1.58	1.58	1.67	0.95
1 1/4" x 1 1/4" x 1"	1DT070708	1.88	1.88	1.82	1.45
1 1/4" x 1 1/4" x 2"	1DT070709	2.10	2.10	1.90	1.75
1 1/2" x 1" x 1/2"	1DT080604	1.41	1.34	1.66	0.95
1 1/2" x 1" x 3/4"	1DT080605	1.52	1.37	1.75	1.14
1 1/2" x 1" x 1"	1DT080606	1.65	1.50	1.80	1.17
1 1/2" x 1" x 1 1/4"	1DT080607	1.82	1.67	1.88	1.34
1 1/2" x 1" x 1 1/2"	1DT080608	1.94	1.80	1.94	1.45

WARNING This product can expose you to chemicals including lead, which is known to the State of California to cause cancer, and which is known to cause birth defects or other reproductive harm. For more information, go to www.P65Warnings.ca.gov.



12600 CARDINAL MEADOW • SUGAR LAND, TX 77478



SUBJECT TO CHANGE WITHOUT NOTICE. GO TO WEB SITE FOR MOST CURRENT PRODUCT INFORMATIONS AND CHANGES OR CONTACT SIGMA PIPING PRODUCTS SALES REPRESENTATIVE FOR ANY ASSISTANCE.
 SIGMA PIPING PRODUCTS © 2020

SPPSigma.com

Reducing Tee Ductile Iron

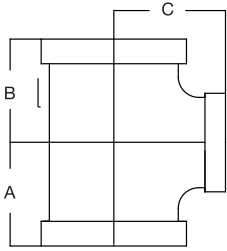

NOM SIZE	ITEM CODE	DIMENSION (IN)			WEIGHT (LBS)	
		BLK	A	B		C
1 1/2" x 1 1/4" x 1/2"	1DT080704		1.41	1.34	1.66	1.05
1 1/2" x 1 1/4" x 3/4"	1DT080705		1.52	1.45	1.75	1.15
1 1/2" x 1 1/4" x 1"	1DT080706		1.65	1.58	1.80	1.25
1 1/2" x 1 1/4" x 2"	1DT080709		2.16	2.10	2.02	1.90
1 1/2" x 1 1/2" x 1/2"	1DT080804		1.41	1.41	1.16	1.15
1 1/2" x 1 1/2" x 3/4"	1DT080805		1.52	1.52	1.75	1.24
1 1/2" x 1 1/2" x 1"	1DT080806		1.65	1.65	1.80	1.30
1 1/2" x 1 1/2" x 1 1/4"	1DT080807		1.82	1.82	1.88	1.48
1 1/2" x 1 1/2" x 2"	1DT080809		2.16	2.16	2.02	1.98
2" x 1" x 2"	1DT090609		2.25	2.02	2.25	2.15
2" x 1 1/4" x 2"	1DT090709		2.25	2.10	2.25	2.30
2" x 1 1/2" x 1/2"	1DT090804		1.49	1.41	1.88	1.50
2" x 1 1/2" x 3/4"	1DT090805		1.60	1.52	1.97	1.62
2" x 1 1/2" x 1"	1DT090806		1.73	1.65	2.02	1.64
2" x 1 1/2" x 1 1/4"	1DT090807		1.90	1.82	2.10	1.80
2" x 1 1/2" x 1 1/2"	1DT090808		2.02	1.94	2.16	2.00
2" x 1 1/2" x 2"	1DT090809		2.25	2.16	2.25	2.35
2" x 2" x 1/2"	1DT090904		1.49	1.49	1.88	1.60
2" x 2" x 3/4"	1DT090905		1.60	1.60	1.97	1.68
2" x 2" x 1"	1DT090906		1.73	1.73	2.02	1.85
2" x 2" x 1 1/4"	1DT090907		1.90	1.90	2.10	2.04
2" x 2" x 1 1/2"	1DT090908		2.02	2.02	2.16	2.18
2" x 2" x 2 1/2"	1DT090910		2.60	2.60	2.39	3.61
2 1/2" x 2" x 3/4"	1DT100905		1.74	1.60	2.32	2.28

 WARNING This product can expose you to chemicals including lead, which is known to the State of California to cause cancer, and which is known to cause birth defects or other reproductive harm. For more information, go to www.P65Warnings.ca.gov.



12600 CARDINAL MEADOW • SUGAR LAND, TX 77478



SUBJECT TO CHANGE WITHOUT NOTICE. GO TO WEB SITE FOR MOST CURRENT PRODUCT INFORMATIONS AND CHANGES OR CONTACT SIGMA PIPING PRODUCTS SALES REPRESENTATIVE FOR ANY ASSISTANCE.
SIGMA PIPING PRODUCTS © 2020

SPPSigma.com